

LANIER



MP C2051/MP C2551

Powerful and compact
colour solutions

Cost-efficient colour production for all office types

The demands on office document production become ever higher. Digital distribution for a fast turnaround is now standard. Colour is increasingly in demand, but document outsourcing eats away at your budget. Lanier™MP C2051/MP C2551 constitute a welcome alternative. Productive, flexible and compact, these colour MFPs offer excellent value for your money. To serve your particular production needs, they are fully customisable. Discover how a host of cutting-edge capabilities can fit inside a slim design.

- Sharp and high-quality colour output with new PxP™ toner.
- Excellent productivity at 20/25 ppm in both colour and B/W.
- Duplexing at simplex speed.
- Exceptionally wide media handling.
- All-round functionality: copying, printing, scanning and faxing (optional).
- Unique internal finisher & punch unit.



Colour flexibility from start to finish

With their remarkably small footprint, the MP C2051/MP C2551 will easily find a place near your desk. That way, you have all their useful functionalities close at hand. Our colour MFPs take care of your entire workflow – scanning, copying, printing, distributing and even finishing.

Flexible scanning

Conveniently send your scanned documents to e-mail or folder with one push of the button. If you wish to avoid burdening your network with extra traffic, scan to URL. Scanning to SD card and USB is optionally available.

In-house document production

For the MP C2051/MP C2551, a unique internal 500-sheet finisher has been developed. It staples and punches your output. Add to your device's excellent print quality and media handling: you have the perfect office production partner. Limit document outsourcing, and produce a number of professional-looking documents in-house.

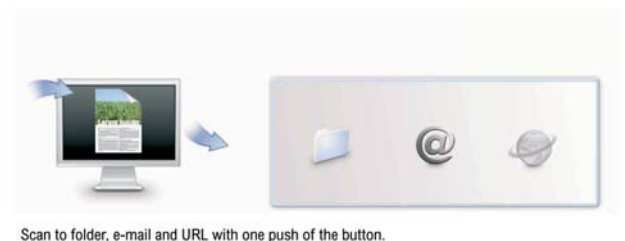

Excellent performance



Superb colours

Your colour output will look crisp and accurate due to the MP C2051/MP C2551's PxP™ toner. Quality remains consistent even during longer runs. Print resolution is a truly outstanding 1,200 dpi.

Wide media range

Creating reports, handouts or flyers? The MP C2051/MP C2551 handle a truly wide variety of paper types. They accept sizes between A3 and A6, from light (52 g/m² via the bypass tray) to heavy (256 g/m² via standard and bypass trays). Glossy and coated papers or card stock are processed effortlessly. Even envelopes and transparencies can conveniently be fed via the standard bypass tray.

Clever business faxing

It takes only one second to scan a fax message, and only two seconds to transmit it. Fax messages can be forwarded to e-mail and to folder. LAN-faxing (directly from PC) and Internet faxing are possible.



Only 2 seconds to transmit.



Crisp and accurate colour output.



LANIER

Simple solutions for complex jobs

Easy operation

With their special handles, the paper trays are very accessible and refills happen fast. Any jammed paper is easily removed from the simplified paper path. Even sophisticated features are straightforward to operate: the MP C2051/MP C2551 have a user-friendly 8.5-inch colour touch screen.

Versatile printing

Enjoy our MFPs' advanced printer features.

- Print and check samples for maximum efficiency.
- Lock prints and release them when a password is entered.
- Hold prints, to be picked up by one user at one moment.
- Store, or store and print jobs.
- Print PDFs directly.
- Print from USB/SD Card (optional).



Easy-to-use Graphical User Interface.



True all-round solutions

Small in size, the Lanier™MP C2051/MP C2551 fulfil a remarkable number of tasks. They copy, print, fax, scan and finish while presenting an outstanding ease of use. Here is true functionality at an attractive cost per page.

Advanced connectivity

Workflows are increasingly managed digitally. The MP C2051/MP C2551 scan to e-mail and folder, SD card and USB flash memory. In the interest of security, they can also send encrypted PDFs. If required, you can increase the standard networking capability. Choose from Wireless LAN, Bluetooth and/or other options.

Data security

Authentication and encryption features protect your confidential data. The MP C2051/MP C2551 are supplied standard with security packages like HDD Data Overwrite and HDD Encryption.



HDD Data Overwrite.

Lanier: green quality



We think green. Do you?



Reliable engines

The MP C2051/MP C2551's engines are the fruit of years of Lanier expertise. Their new tandem 4-drums design ensures reliable operation. A simplified paper path reduces the risk of jams, and your machine is continuously available. With a maximum paper capacity of 1,600 sheets, refills are kept to a minimum.

We think green, and you?

Lanier developed the industry's first polyester polymerisation (PxP™) toner, which is chemically manufactured using polyester resin materials, colouring agents, and wax to ensure higher copying and printing quality. Compared with traditional toners, the energy and CO₂ emissions required to manufacture the PxP™ toner is reduced by approximately 35%. In addition, the PxP™ toner requires a fusing temperature 20°C lower than traditional toners. This, in turn, contributes to energy conservation.

Green DOCutivity

Lanier has already assisted many large corporate customers in achieving substantial savings in overall costs and environmental impact. Via our Green DOCutivity (g-doc) process, our trained staff audit and analyse your current device usage, energy consumption, and paper use. Based on this information, we create an optimisation scenario which not only reduces your Total Cost of Ownership (TCO), but also reduces your energy use, paper costs, and carbon footprint. The result? A significant improvement to your business processes, which makes your business leaner and greener.

@Remote

@Remote from Lanier puts you back in control. This intelligent Remote Management System monitors exactly how much and how often your devices are being used. You no longer have to manually record and forward device meter readings - with @Remote all this is done automatically, providing more accurate billing information and allowing company employees to get on with more important daily tasks.

@Remote delivers four key benefits...

- Auto meter reading
No more running around, @Remote puts you back in control
- Auto toner replenishment
It's often the case that toner runs out just when you need it most
- Auto fault notification
Our automated service call feature means faults are notified to our Lanier helpdesk automatically
- Detailed usage reports
How do you really know whether all the devices across all departments in all your buildings accurately meet the needs of their users?

LANIER

MP C2051/MP C2551

COPIER

Copying process:	Dry electrostatic transfer system		
Copy speed:	MP C2051:	B/W / full colour:	20 copies per minute
	MP C2551:	B/W / full colour:	25 copies per minute
Resolution:	600 dpi		
Multiple copy:	Up to 999		
Warm-up time:	Less than 22 seconds ¹		
First output speed:	Black and white:	Less than 6.3 seconds	
	Full colour:	Less than 9.2 seconds	
Zoom:	25 - 400% (in 1% steps)		
Memory:	Standard:	1.5GB RAM and 160 GB HDD	
Paper input capacity:	Standard:	2 x 250-sheet paper trays 1 x 100-sheet bypass tray	
	Maximum:	1,600 sheets	
Paper output capacity:	Maximum:	550 sheets	
Paper size:	A6 - A3		
Paper weight:	Paper tray 1:	60 - 256 g/m ²	
	Paper tray 2:	60 - 169 g/m ²	
	Bypass tray:	52 - 256 g/m ²	
	Duplex tray:	60 - 105 g/m ²	
Dimensions (W x D x H):	587 x 655 x 845 mm (with ARDF)		
Weight:	Less than 100 kg (with ARDF)		
Power source:	220 - 240 V, 50/60 Hz		
Power consumption:	Operation:	Maximum 1,680 W ¹	

PRINTER

Print speed:	MP C2050:	B/W / full colour:	20 prints per minute
	MP C2550:	B/W / full colour:	25 prints per minute
Printer language:	Standard:	PCL5c, PCL6	
	Option:	Adobe® PostScript® 3™	
Resolution:	1,200 dpi		
Interface:	Standard:	USB 2.0 Host USB Device	
		Ethernet 10 base-T/100 base-TX IEEE 1284	
	Option:	Wireless LAN (IEEE 802.11a,g) Ethernet 1000 base-T	
Network protocol:	TCP/IP (IPv4, IPv6), IPX/SPX, AppleTalk		
Supported environments:	Windows® 2000/XP/Vista/Server 2003/Server 2008/7		

SCANNER (Option)

Scan speed maximum:	B/W:	44 images per minute (LEF, A4)
	Full colour:	44 images per minute
Resolution:	Maximum 600 dpi	
Original size:	A5 - A3	
Output formats:	PDF/JPEG/TIFF/High compression PDF	
Bundled drivers:	Network, TWAIN	
Scan to e-mail:	SMTP, POP3	
Scan to e-mail destination addresses:	Maximum 500 per job	
Stored destination addresses:	Maximum 2,000	
Address book:	Via LDAP or locally on Hard Disk Drive	
Scan to folder:	SMB, FTP, NCP	
Destination:	Maximum 50 folders per job	

SOFTWARE

SmartDeviceMonitor™
Web SmartDeviceMonitor™
Web Image Monitor
DeskTopBinder™ Lite/Professional/v.5

FAX (option)

Circuit:	PSTN, PBX	
Compatibility:	ITU-T (CCITT) G3	
Modem speed:	Maximum 33.6 Kbps	
Resolution:	Standard/detail:	200 x 100/200 dpi
	Maximum:	400 x 400 dpi (option)
Compression method:	MH, MR, MMR, JBIG	
Scanning speed:	36 sheets per minute	
Memory capacity:	Standard:	4 MB
	Maximum:	28 MB
Memory backup:	Yes	

OTHER OPTIONS

500-sheet paper tray, 2 x 500-sheet paper trays, Caster table, Cabinet, Internal 500 sheet finisher, Punch unit, Shift tray, Inner one bin tray, Side tray, Fax unit, Fax stamp ink, PictBridge, Counter interface unit type A, Key counter bracket, Remote communication gate BN1, Unicode font package for SAP, SAF memory, Browser unit, USB2.0/SD slot, File Format Converter, GlobalScan NX, Card authentication package, Professional software solutions.

¹ Warm-up time and power consumption may differ depending on the conditions and environment of the machine.

For availability of models, optional apparatus and software, please consult your local Lanier supplier.



LANIER

Hardware | Systems | Peripherals | Tools

Visit us at www.lanier.com.au

TELEPHONE

1 300 000 000

AUTHORISED DEALER